

Solenoid Pump CSM-1 Series Model: CSM-16025

PRODUCT INFORMATION

Pump Design Solenoid (Piston) Pump
Insulation Class "F" for TUV, Class "H" for UL
Net Weight 0.145 Kg
Outlet Connector Barb port / Thread
Recognition TUV , UL

PERFORMANCE SPECIFICATIONS

COIL MOTOR

- CSM-E16025 220~240 VAC, 50Hz , 22W
- CSM-U16025..... 120 VAC, 60Hz , 24W
- CSM-J16025..... 100 VAC, 50/60Hz , 24W

Flow rate at 0 bar..... 800 cc/min
Obstructed pressure 2.5 BAR (36.25 PSI)
Work condition 2 min on / 1min off
Self-priming at 0 BAR (0 PSI)

Suitable to dry-use only during priming
Laboratory test condition..... 2/1min, Ta: 60°C, Tf: 35°C
 2/1min: 2min on, 1 min off
 Ta: Ambient temperature
 Tf: Temperature of fluid water

* Table 1

XX – The Code of Flow Rate (FR) Table

XX	FR (cc/min)
13	650
16	800
20	1000

* Table 2

YYY – The Code of Pressure(bar) table

YYY	PRESSURE (BAR)
025	2.5
020	2.0
030	2.0

PRESSURE – FLOW RATE CURVE

Model: CSM-16025

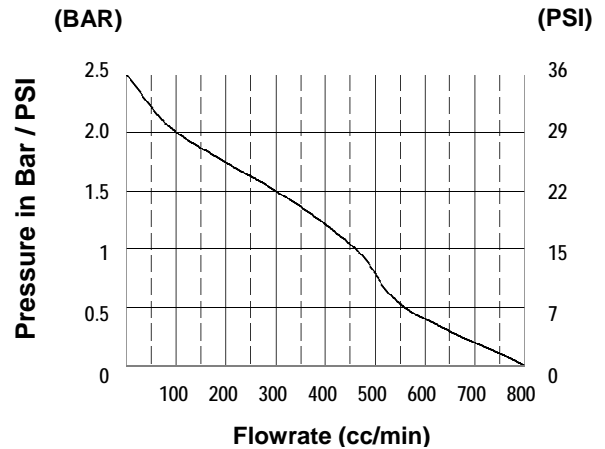

Note : - All the performance are intended with a tolerance $\pm 15\%$
 - Water 20°C, Ambient 25°C

STANDARD MODEL NUMBERING SYSTEM

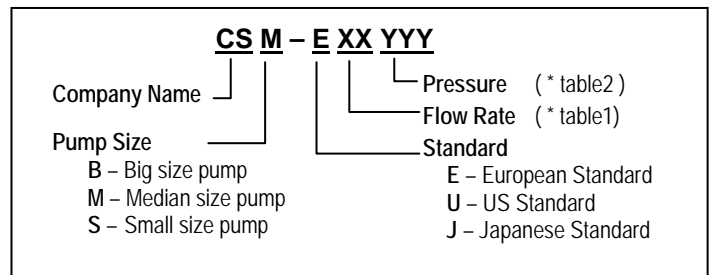

APPLICATIONS

- Espresso coffee machine
- Steam generator
- Steam Iron
- Steam vacuum cleaner
- Disco smoke generator

Mechanical Drawing & Dimension

Model: CSM-16025

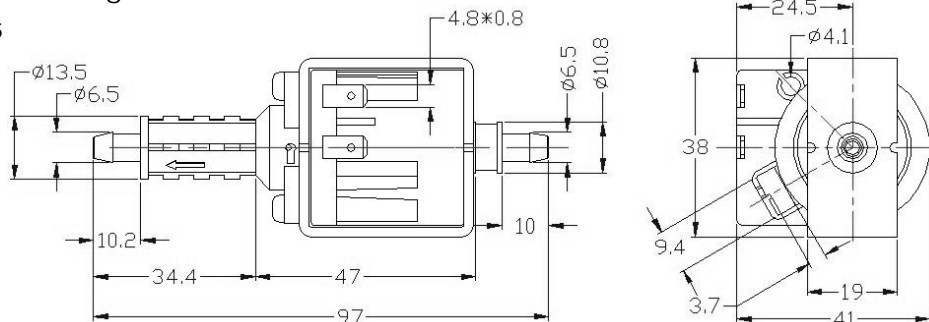

華星企業香港有限公司
 China Star Enterprise Hong Kong Ltd.
 中山華通五金塑料制品有限公司

地址：香港柴灣安業街八號合明工業大廈十四樓 C 座
 深圳代表處：深圳市南山科技园，科智西路 5 号，25 栋二段三樓 518057
 Add: South - 3/F, 25# Building, 5 Kezhixi Rd. Science Park, Nanshan District, Shenzhen, PRC 518057
 Tel: (86) 0755-2661 5378 Fax: (86) 0755-2661 5758
 www.solenoidpump.com.cn info@solenoidpump.com.cn