

Solenoid Pump CSB Series

Model: CSB-E20035

PRODUCT INFORMATION

Pump DesignSolenoid (piston) Pump
InsulationClass "F" for TUV, Class "B " for UL
Net weight0.35Kg
Outlet ConnectorG 1/8"
Recognition.....TUV , UL

PERFORMANCE SPECIFICATIONS

COIL MOTOR

- CSB-E20035 220-240 VAC, 50Hz , 48W
- CSB-U20035 120 VAC, 60Hz , 48W
- CSB-J20035 100VAC, 50/60Hz ,48W

Ideal fluid Water at 25°C

Ambient temperature 60 °C

Flow rate at 0 bar 1000 cc/min

Obstructed pressure3.5 bar

Suitable to dry-use only during priming

Laboratory test condition.....Ta:60°C, Tf:35°C

PRESSURE – FLOW RATE CURVE

Model: CSB-E20035

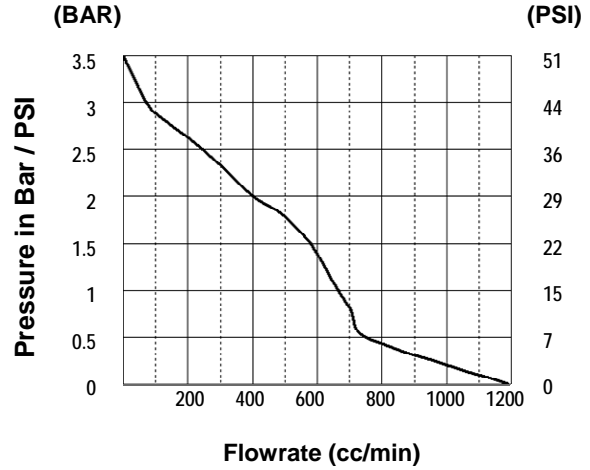

Note : - All the performance are intended with a tolerance $\pm 15\%$
 - Water 20°C, Ambient 25°C

XX – THE CODE OF FLOW RATE (FR) TABLE

XX	FR (ml/min)	XX	FR (ml/min)	XX	FR (ml/min)
08	400	16	800	24	1200
09	450	17	850	25	1250
10	500	18	900	26	1300
11	550	19	950	27	1350
12	600	20	1000	28	1400
13	650	21	1050	29	1450
14	700	22	1100	30	1500
15	750	23	1150		

Table 1

STANDARD MODEL NUMBERING SYSTEM

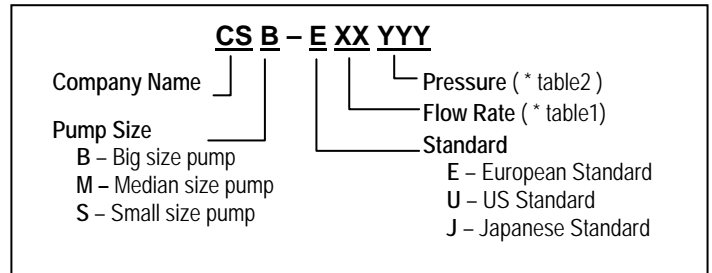

YYY – THE CODE OF PRESSURE TABLE

YYY	PRESSURE (bar)	YYY	PRESSURE (bar)	YYY	PRESSURE (bar)
020	2.0	040	4.0	150	15.0
025	2.5	045	4.5	200	20.0
030	3.0	048	4.8		
035	3.5	060	6.0		

Table 2

APPLICATIONS

- Espresso coffee machine
- Steam generator
- Steam Iron
- Steam vacuum cleaner
- Disco smoke generator

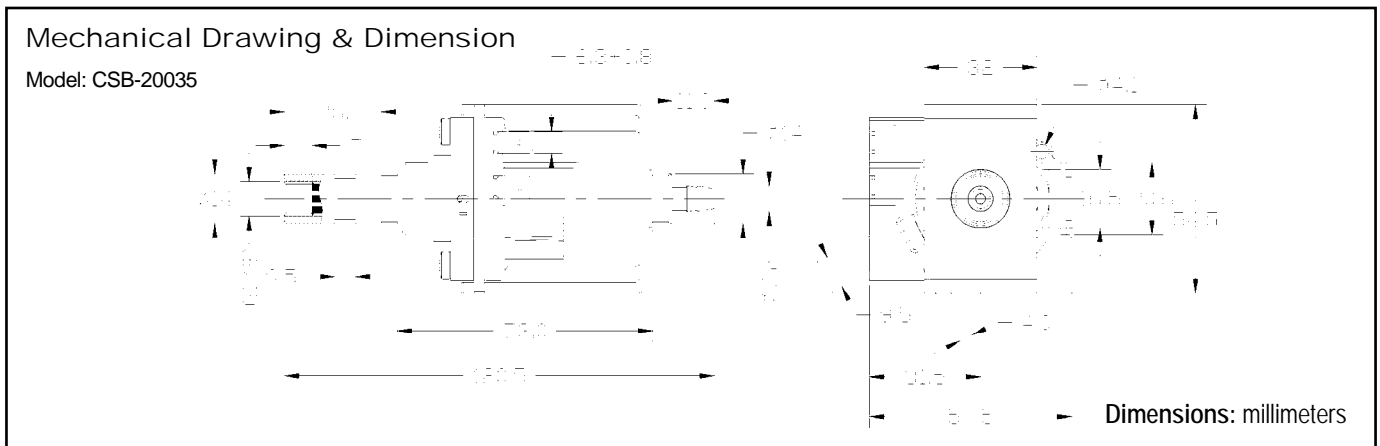

華星企業香港有限公司
 China Star Enterprise Hong Kong Ltd.
 中山華通五金塑料制品有限公司

地址：香港柴灣安業街八號合明工業大廈十四樓 C 座
 深圳代表處：深圳市南山科技园科智西路 5 号 25 栋东二段南三层 518057
 Add: South 3/F, Block 25, 5 Kezhixi Rd. Science Park, Nanshan District, Shenzhen, PRC 518057
 Tel: (86) 0755-2661 5378 Fax: (86) 0755-2661 5758
 info@solenoidpump.com.cn www.solenoidpump.com.cn